



# TEST REPORT

## Handle for dust mop

Test item: Autoclave  
Report no.: DL-191105-2  
Test date: 05.11.2019  
Issue date: 05.11.2019

### Handle for dust mop



42501  
42701

For test results please see next page



# TEST METHOD

## Handle for dust mop



### Test conditions:

<b>Procedure</b>	1 x wash + 1 x autoclave (= 1 cycle) Test result after 3 cycles
<b>Wash</b>	Industrial washing machine, 11 kg: 60 °C Load: 60% (6.6 kg) Detergent: pH 11 No dry tumbling
<b>Autoclave</b>	Is used right after wash 121 °C 30 min.

**Autoclave is a specially developed machine for sterilisation of products. The machine is filled with steam under pressure. The product is being exposed to saturated steam with a temperature of 121 °C in 30 minutes.**





# TEST RESULT

## Handle for dust mop

<b>Test result 1</b> (-) decrease (+) increase	<b>Width</b>	<b>Length</b>
<b>Shrinkage</b>	+3.3%	-2.9%
<b>Art. no.</b>	42501 42701	

### Test result 2

Visual check after autoclaving:

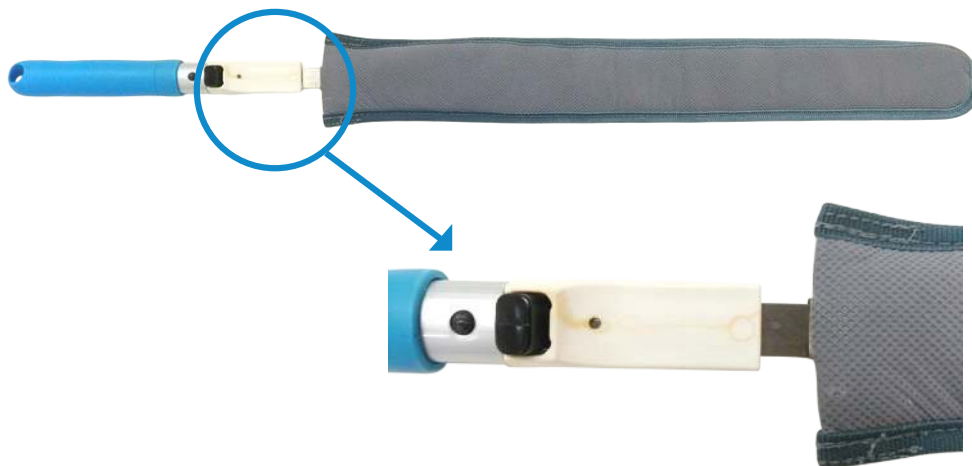

- The stainless steel is being exposed due to shrinkage on the grey part
- Rust-coloured water is found and can discolour other products
- The color bleaches after autoclaving
- Additional shrinkage can occur after repeated autoclaving